

# HAVENS LANE SUBDIVISION

LOCATED IN THE W 1/2 NE 1/4 NE 1/4 SEC. 18, T.21N., R.22E., B.M. LEMHI COUNTY, IDAHO

## CERTIFICATE OF ENGINEER

This is to certify that I, KENT J. UTLEY, a Registered Professional Engineer in the State of Idaho made the survey of land as described in the certificate of owners, and designated herein as Havens Lane Sub-division and that this plat is a true and correct representation of said survey as made and staked by me on said land.

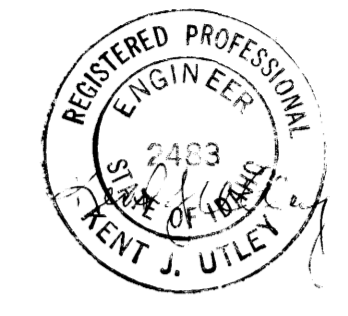

## CERTIFICATE OF OWNERS

This is to certify that we are the owners in fee simple of the following described property: A portion of the W 1/2 NE 1/4 NE 1/4 Section 18, T.21N., R.22E., B.M., Lemhi County, Idaho, said property being more specifically described as follows;

Commencing at the Northeast corner of Section 18, thence N.89° 49' W. along the Northerly boundary of Section 18 a distance of 660.0 feet; thence S. 0° 05' W. along the Easterly boundary of the W 1/2 NE 1/4 NE 1/4 of Section 18 a distance of 331.2 feet to the point of beginning, said point being the Northeast corner of the tract of land herein described; continuing thence S. 0° 05' W. 988.8 feet, more or less, to a point on the Southerly boundary of the NE 1/4 NE 1/4 of Section 18, thence N.89° 49' W. along said boundary a distance of 660.0 feet to the Southwest corner of the NE 1/4 NE 1/4 of Section 18, thence N. 0° 05' E. along the Westerly boundary of the NE 1/4 NE 1/4 of Section 18 a distance of 988.8 feet to a point which lies 331.2 feet South of the Northerly boundary of Section 18, thence S.89° 49' E., 660.0 feet to the point of beginning.

The area contained in this platted land as described is 14.98 acres.

It is the intention of the undersigned to and they do hereby include said land in this plat, that the undersigned does by these presents dedicate to the public for public use forever all streets as shown on this plat. The easements indicated on this plat are not dedicated to the public, but the rights to use said easements are hereby perpetually reserved for public utilities, and no structures other than for such utilities are to be erected within the lines of said easements.

<u>Roy E. Infanger</u>	<u>Vera S. Infanger</u>
<u>Gary C. Hawkins</u>	<u>Linda Hawkins</u>
<u>Alanzo R. Mathews</u>	<u>Martha L. Mathews</u>
<u>Roy Hoffman</u>	<u>Sharon Hoffman</u>
<u>Thomas U. Hawkins</u>	<u>Barbara A. Hawkins</u>
<u>Alvin Peterson</u>	

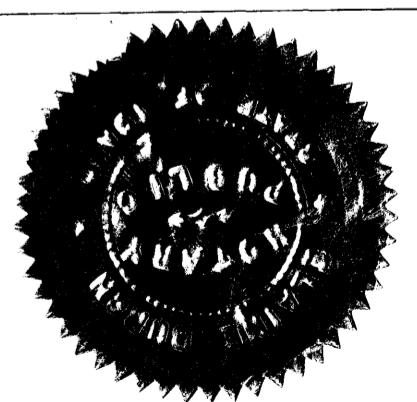

ENGINEER: KENT J. UTLEY, P.E.  
DRAWN BY: C.W. SHAW 7/21/73  
SCALE: 1" = 100'

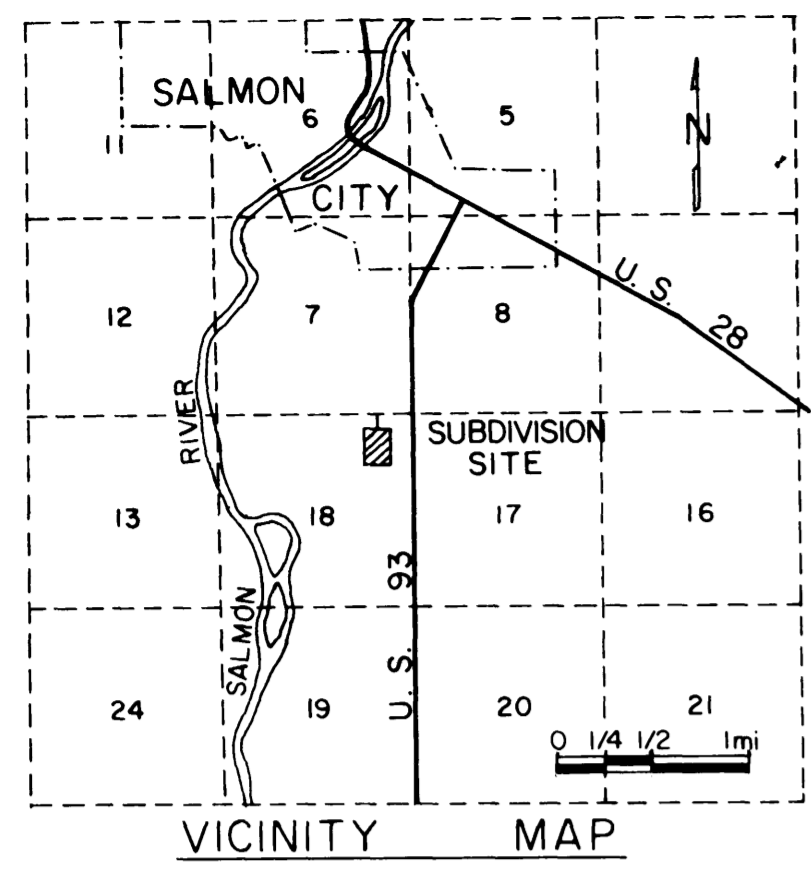

RECORD BEARING N.89°49'W. RECORD DIST. 660.00'  
(FOUND) 654.9'

CONLEE LANE

CITY AND COUNTY PLANNING COMMISSION REVIEW

We have reviewed this plat and recommend it's approval.

Robert J. Gramer  
Salmon City Chairman

Michael Quascha  
Lemhi County Chairman

### BASIS OF BEARING

Record Bearing from the NE Cor. Sec. 18 to the N 1/4 Cor., Sec. 18  
Error of Closure is 1 part in 3700

### LEGEND

- 5/8" Steel bars set as boundary corners by L.S. No. 655 prior to subdivision survey
- 5/8"x30" Steel bars set as boundary corners
- 1/2"x24" Steel bars set as lot corners
- Boundary line
- Lot line
- - - Utility easement
- Existing fence
- ③ Lot number

### COUNTY COMMISSIONER'S ACCEPTANCE

The foregoing plat is duly accepted and approved. Maintenance of all public streets (when such streets are improved to county standards) will be accepted by the Board of County Commissioners of the County of Lemhi, Idaho

14<sup>th</sup> day of October, 1975

Edna M. Wilson Attest Clerk  
Charles B. Hume Chairmen

### ACKNOWLEDGEMENT

State of Idaho S.S.  
County of Lemhi

On this 20<sup>th</sup> day of January, 1975, before me, a Notary Public in and for said state personally appeared the persons whose names are subscribed to the foregoing Certificate of Owners and acknowledged to me that they executed the same.  
IN WITNESS WHEREOF I have hereunto set my hand and affixed my official seal.

Glenn Burch  
Notary Public for the State of Idaho

### SANITARY RESTRICTIONS

Each lot in this subdivision shall be connected to an individual sewer & central water system constructed to Idaho Department of Health standards.

### ACREAGE

Record 14.98 Acres  
Found 15.07 Acres

### COUNTY RECORDERS CERTIFICATE

State of Idaho S.S.  
County of Lemhi

This is to certify that the forgoing plat was filed in the Office of the Recorder of Lemhi County, Idaho on this 14<sup>th</sup> day of October, 1975, at 2:52 P.m, and duly recorded in Plat Book 4 at Page 49.

Edna M. Wilson  
Ex-Officio Recorder

